

AMS-XX-2.3-9,0 motor

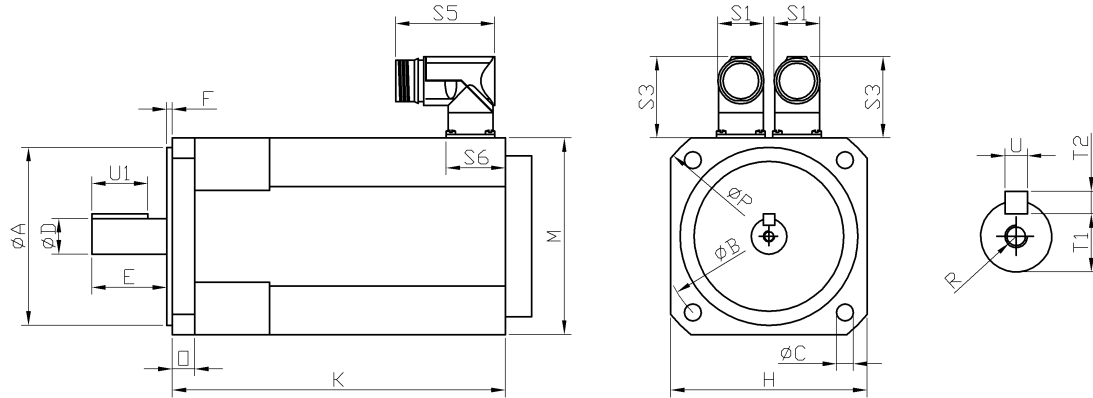

Dimensions

Type	size	A (j6)	B	C	D (k6)	E	F	H	K	M	O	P	R	S1	S3	T1	T2 (h9)	U (h9)	U1
AMS-R0-2.3-9,0	2.3	95	115	9	19	40	3	105	228	105	12	134	M6.15	26	40	15,5	6	6	30
AMS-RB-2.3-9,0	2.3	95	115	9	19	40	3	105	268	105	12	134	M6.15	26	40	15,5	6	6	30
AMS-E0-2.3-9,0	2.3	95	115	9	19	40	3	105	242	105	12	134	M6.15	26	40	15,5	6	6	30
AMS-EB-2.3-9,0	2.3	95	115	9	19	40	3	105	282	105	12	134	M6.15	26	40	15,5	6	6	30

Torque/Speed diagram

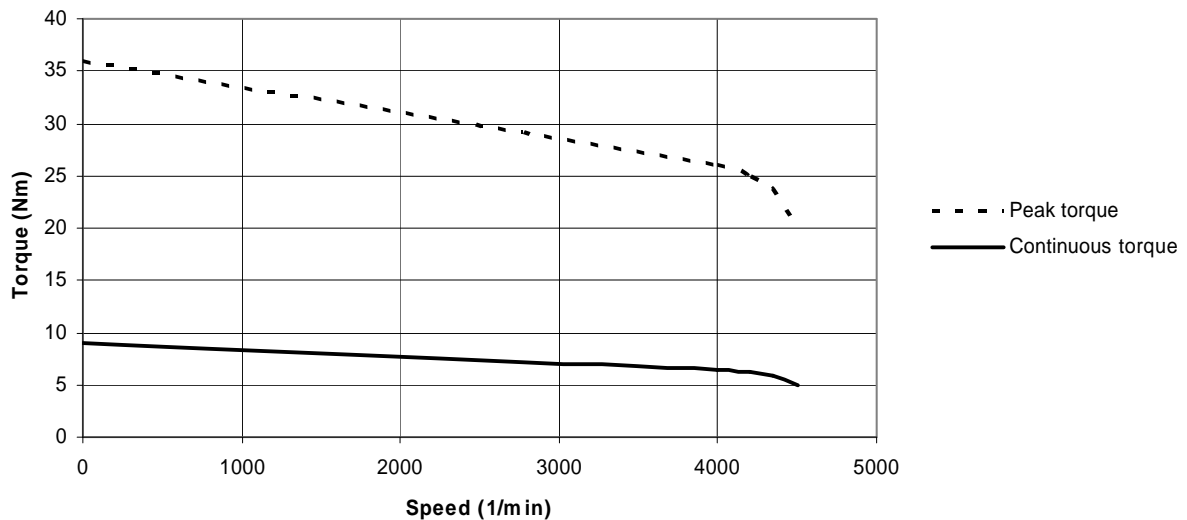

Technical data

Denomination	Symbol	Unit	AMS-XX-2.3-9,0/L	AMS-XX-2.3-9,0/H
Rated power	P_N	KW	2,72	2,72
Rated torque	M_n	Nm	6,5	6,5
Stillstand continuous torque	M_o	Nm	9	9
Stillstand peak torque	M_{om}	Nm	36	36
Rated current	I_n	A	13,2	6,6
Stillstand continuous current	I_o	A	18,3	9,2
Rotor inertia	J	kgcm ²	3,6	3,6
Mass	m	kg	10,5	10,5
Armature resistance (phase to phase)	R_a	?	0,47	1,3
Armature inductance (phase to phase)	L_a	mH	1,9	7,6
Thermal time constant	T_{thN}	min.	38	38
Voltage constant	K_E	V/1000 turn	33	60
Torque constant	K_T	Nm/A	0,49	0,98