

AMS-XX-3.4-34 motor

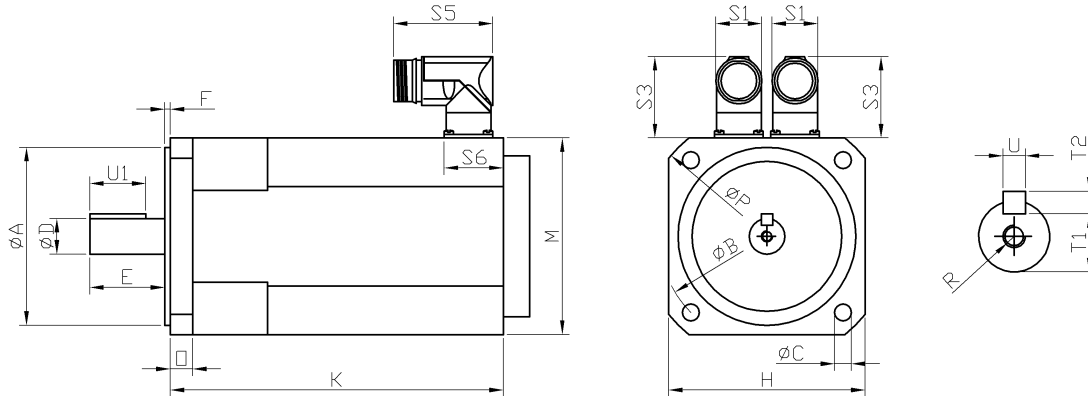

Dimensions

Type	size	A (j6)	B	C	D (k6)	E	F	H	K	M	O	P	R	S1	S3	T1	T2 (h9)	U (h9)	U1
AMS-R0-3.4-34	3.4	130	165	11	24	50	3,5	145	420	145	12	188	M8.25	26	40	19,9	8	8	40
AMS-RB-3.4-34	3.4	130	165	11	24	50	3,5	145	463	145	12	188	M8.25	26	40	19,9	8	8	40
AMS-E0-3.4-34	3.4	130	165	11	24	50	3,5	145		145	12	188	M8.25	26	40	19,9	8	8	40
AMS-EB-3.4-34	3.4	130	165	11	24	50	3,5	145		145	12	188	M8.25	26	40	19,9	8	8	40

Torque/Speed diagram

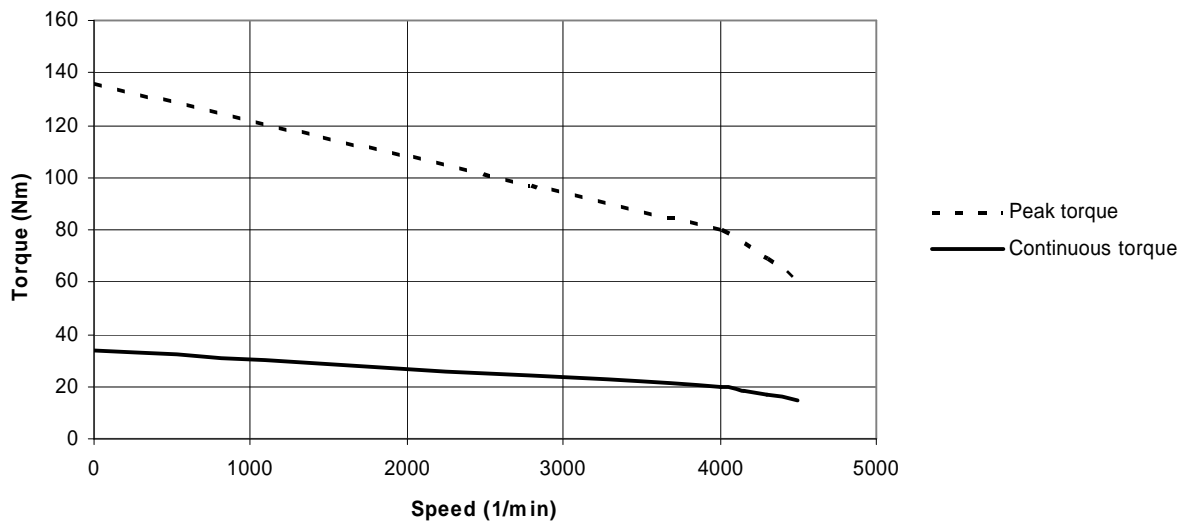

Technical data

Denomination	Symbol	Unit	AMS-XX-3.4-34/H
Rated power	P_N	KW	8,37
Rated torque	M_n	Nm	20
Stillstand continuous torque	M_o	Nm	34
Stillstand peak torque	M_{om}	Nm	136
Rated current	I_n	A	19,3
Stillstand continuous current	I_o	A	33
Rotor inertia	J	kgcm ²	12,5
Mass	m	kg	30
Armature resistance (phase to phase)	R_a	?	0,3
Armature inductance (phase to phase)	L_a	mH	3,8
Thermal time constant	T_{thN}	min.	88
Voltage constant	K_E	V/1000 turn	65
Torque constant	K_T	Nm/A	1,04